



KEEP WORKERS
PROTECTED WITH
**THE RIGHT
WELDING
SOLUTIONS**



WELDING SAFETY

- 4 Welding Helmets & ADFs
- 25 PAPR
- 26 Accessories/Headgear/Filters
- 30 Electric Line/Contour
- 34 Welding Curtains & Accessories

WELDING SAFETY

Designed to perform in a range of welding conditions, Jackson Safety* Brand Helmets are available in a variety of materials including vulcanized fiber. Choose from a selection of filters — from passive to digital ADF platforms and numerous graphic designs to reflect personal style.





Why Choose Kimberly-Clark Professional* SAFETY AND INDUSTRIAL SOLUTIONS?

Because we offer protection and comfort without compromise – to safeguard workers, their environments and work processes. Our full range of personal protection products are designed to meet the needs of virtually any facility, while enhancing efficiency and performance. Our wiping solutions are consistent and reliable, an ideal replacement for paper towels, rags and shop towels. We offer something that our competitors do not: A way to divert used gloves and apparel from the landfill. Turn to our trusted, quality brands to enhance safety, compliance and sustainability in your workplace.

JACKSON*
SAFETY Brand

WELDING HELMETS

*Passive helmets offer great protection.
Auto-Darkening Filter helmets offer
protection and productivity.*

PASSIVE VS. AUTO-DARKENING FILTER HELMETS

Both passive and Auto-Darkening Filter (ADF) welding helmets provide excellent eye protection. Research shows that ADF helmets also offer impressive productivity gains, as well as greater user comfort.

According to a study¹ comparing the productivity of a passive and an ADF unit:

- 3% of a welder's day is spent lifting and nodding his/her helmet
- An ADF eliminates the need to "lift and nod" the helmet
- Use of an ADF will put \$500 per year, per welder, back in the company's pocket
- Use of an ADF can recapture 12 minutes per day in productivity per welder

Our **Auto-Darkening Filter Productivity & Profitability Calculator** can show you just how much money you can save – and how much productivity you can gain – using our ADF welding helmets.

ADDED BENEFITS OF AN ADF

- **Increased accuracy** because the welder can always see what he's doing, and start in exactly the right spot
- **Increased comfort** by eliminating the repetitive "lifting and nodding" that can cause neck strain
- **Increased protection** from injuries caused by welding, chipping or grinding in the proximate area
- **Increased peace of mind** because even if the ADF should not become active during an arc, it still protects eyes from serious damage
- **Increased productivity** by eliminating the time it takes to lift and nod the helmet before and after each weld

¹ Productivity Claim for Welders Using an Auto-Darkening Filter (ADF) Helmet Vs a Passive Helmet (Research Summary). Date: 7/29/2010. Authors: Cerita D. Bethea, Rick Zepp, Sandy Erreger, Martha Tate, Audra Wright



Jackson Safety® Auto-Darkening Filter (ADF) Warning

- Provides limited eye protection; Additional protective devices are required for full eye coverage and protection
- Should not be worn to protect from other hazards including, but not limited to, airborne dusts or mists, liquid splashes, impact hazards and sports activities

The selection and use of welding personal protective equipment must be based on a hazard assessment of the wearer's work environment conducted by the wearer, or for an industrial environment, an appropriately trained individual for your employer or organization in accordance with OSHA regulations 29 CFR 1910.133 and ANSI Standard No. Z87.1. Make sure the ADF is installed properly into the helmet shell and is clean. If the ADF is scratched or damaged, do not use it and replace it with a new one. Do not use the ADF without the Jackson Safety® Brand Internal and External Safety Plates. To clean, wipe only with a soft cloth. Do not immerse ADF in liquids.



• Registration needed to be eligible for 5-year warranty

• 5-year warranty only for ADFs with Balder* Technology

WELDING HELMET SELECTION GUIDE

Follow the easy-to-use selection guide below to find the helmet and filter with features that best suit your needs, experience and budget.

Jackson Safety* Helmet Portfolio

<p>Passive</p> <ul style="list-style-type: none"> • Traditional passives • Specialty applications 	<p>ADF — Digital</p> <ul style="list-style-type: none"> • Entry-level ADFs • Professionals who need value 	<p>ADF</p> <ul style="list-style-type: none"> • High-performance ADFs • Professionals who need results and performance 	<p>ADF — Digital with Balder* Technology</p> <ul style="list-style-type: none"> • Best-quality ADFs • High optical clarity • Premium solutions
<p>CLASSIC</p> <ul style="list-style-type: none"> • Passives • Specialty segments 	<p>STANDARD</p> <ul style="list-style-type: none"> • Insight* • SmarTIGer* 	<p>PERFORMANCE</p> <ul style="list-style-type: none"> • NexGen* • Balder* BH3* 	<p>STATE-OF-THE-ART</p> <ul style="list-style-type: none"> • TrueSight* II  <p>BALDER* TECHNOLOGY</p>

SEE THE DIFFERENCE WITH BALDER* TECHNOLOGY



View with Jackson Safety* ADF Helmet with Balder* Technology



View with competitive ADF

Balder* Technology has achieved the highest rating for optical quality and the best classification for “angular dependence.” The 1 / 1 / 1 / 1 rating is for Optical Quality, Light Scattering, Homogeneity, and Angular Dependence. That means it gives the welder the flexibility to see clearly at many different angles. With Jackson Safety* ADF Welding Helmets with Balder* Technology you get a clear view from various angles which can reduce eye fatigue and the need to move, adjust and refocus, and superior optical quality that allows you to do your best work.

Select the right ADF for your application

Process	TrueSight* II	Balder* BH3*	NexGen*	SmarTIGer*	Insight*	Nitro* Variable	Element* Variable	Solera	Element*
Shielded Metal Arc (SMAW) "Stick"	•	•	•	•	•	•	•	•	•
Gas Metal Arc (MIG)	•	•	•	•	•	•	•	•	•
MIG < 5 amps	•	•	•	•	•				
Pulse MIG	•	•	•	•	•				
Gas Tungsten Arc (TIG)	•	•	•	•	•	•	•	•	•
TIG < 5 amps	•	•	•	•	•				
Pulse TIG	•	•	•	•	•				
Plasma Arc (PAW)	•	•	•	•	•	•	•	•	•
Submerged Arc (SAW)	•	•	•	•	•	•	•	•	•
Carbon Arc Gouging	•	•	•	•	•	•	•		
Stud Arc	•	•	•	•	•	•	•	•	•
ElectroGas (EGW)	•	•	•	•	•	•	•	•	•
Electroslag (ESW)	•	•	•	•	•	•	•	•	•
Flux Cored Arc (FCAW)	•	•	•	•	•	•	•	•	•
Torch & Grind Functionality	•		•						

WELDING HELMET STYLES

Jackson Safety Welding Helmets come in a variety of styles and types of helmets to suit your welding needs. The three different types of shells highlight the varying levels of performance within the Jackson Safety* Welding Helmet product line.*

HSL 100



- Narrow shell design is perfect for work in tight spaces
- Extended front increases throat protection from sparks, slag and other physical hazards

Halo X (HLX)



- Ultra lightweight shell – only weighs 6 ounces
- Lightweight shell helps reduce neck tension
- Hydraflex* Shell provides the ultimate in flexibility and durability

BH3*



- Curved front cover plate offers reduced heat buildup, reflections and fogging than the HSL-100
- Aerodynamic shell designed for better fume deflection than the HSL-100
- Smooth, rounded perimeter for increased comfort
- Quick and easy replacement of safety plates



Welding helmet designs and colors are an extension of your personality. Jackson Safety* Welding Helmets come in solid colors as well as several graphic hoods. Select the helmet design that's right for you.

Graphic Welding Helmet Designs

	Heavy Metal	I ²	Arc Angel	Ace of Spades	Carbon Fiber	Renegade
						
TrueSight* II			•	•		
NexGen*	•	•	•	•	•	•
Insight*		•	•			
Halo X Passive	•				•	

	Tattoo	Serpent	Gold Wings	Stars & Scars	Flaming Butterfly	Metal
						
TrueSight* II	•	•	•	•	•	•
NexGen*						
Insight*			•	•	•	•

With over 75 years of service, Jackson Safety* Welding Safety Products, known and trusted worldwide, offer a range of the finest safety products available.

Jackson Safety* HARD HAT INTERCHANGE SYSTEM

The All-In-One Safety Solution. Injuries can happen in a split second — even during the time it takes to remove a hard hat when you need a face shield or welding helmet.

Now it's easy to stay protected at all times with the Jackson Safety* Hard Hat Interchange System from Kimberly-Clark Professional*. It lets you easily add, remove or switch between your welding helmet or face shield — all without removing your hard hat.



Look for this symbol for items compatible with the **Hard Hat Interchange System**



VARIABLE AUTO-DARKENING FILTER WITH BALDER* TECHNOLOGY

	<i>TrueSight* II</i>	<i>Balder* BH3*</i>
Part No.	46159	46147
Light Shade	4	4
Viewing Area	3.25" x 4"	2.7" x 3.8"
Shades	5-8/9-13	9-13
Grind Mode	Yes	No
Torch Mode	Yes	No
Typical Switching Speed	1/8700	1/6667
Solar	Yes	Yes
Replaceable Batteries	Yes	No
Sensors	4	2
Sensitivity & Delay Controls	Yes	Yes
TIG Rating	< 5 Amps	< 5 Amps
Controls	Digital	Dial
Warranty	5 Years	5 Years
Optical Classification	1/1/1/1	1/1/1/1

The **BH3* Helmet with Balder* Technology** has achieved the highest rating for optical quality and the best classification for "angular dependence." That means it gives the welder the flexibility to see clearly at many different angles. With new Jackson Safety* ADF Welding Helmets with Balder* Technology you get a clear view from various angles which can reduce eye fatigue and the need to move, adjust and refocus, and superior optical quality that allows you to do your best work.



TrueSight* II Digital Variable ADF Welding Helmet with Balder* Technology



HLX (Serpent) with TrueSight* II ADF



Digital Controls

Code	Description	Units/Case	Product Features
46159	HLX Welding Helmet with TrueSight* II Digital ADF – Black	1	<ul style="list-style-type: none"> • Intuitive, digital control panel • Optical class 1/1/1/1 • Features variable shade 5-13, sensitivity and delay adjustments • Large, separate buttons with LED indicator for Weld, Torch and Grind modes • Four independent sensors positioned to reduce possibility of blockage during weld • Two, easy-to-replace AAA batteries included; low-battery indicator • Green band pass for enhanced clarity of weld puddle • No retainer for easy helmet installation and removal • Built-in magnification lens holder • Meets ANSI Z87.1-2010 and CSA Z94.3 Compliant • DIN Plus Certified
46160	HLX Welding Helmet with TrueSight* II Digital ADF – Tattoo	1	
46162	HLX Welding Helmet with TrueSight* II Digital ADF – Serpent	1	
46163	HLX Welding Helmet with TrueSight* II Digital ADF – Arc Angel	1	
46164	HLX Welding Helmet with TrueSight* II Digital ADF – Ace of Spades	1	
46111	HLX Welding Helmet with TrueSight* II Digital ADF – Gold Wings	1	
46118	HLX Welding Helmet with TrueSight* II Digital ADF – Stars & Scars	1	
46119	HLX Welding Helmet with TrueSight* II Digital ADF – Flaming Butterfly	1	
46120	HLX Welding Helmet with TrueSight* II Digital ADF – Metal	1	
46158	TrueSight* II ADF Cartridge, 4.5 x 5.25	1	
30320	TrueSight* II External Safety Lens	10	
30321	TrueSight* II Internal Safety Lens	10	
20696	370 Replacement Headgear	6	



Black



Tattoo



Arc Angel



Ace of Spades



Gold Wings



Stars & Scars



Flaming Butterfly



Metal

BH3* Variable ADF Welding Helmet with Balder* Technology



Code	Old Code	Description	Units/Case	Product Features
46157	—	BH3* Welding Helmet DS with Balder* Technology ADF – Black	1	<ul style="list-style-type: none"> • Superior angle of view • Enhanced visibility and color recognition • Variable shade (9-13), adjustable sensitivity and opening time delays • Curved front cover plate offers reduced heat buildup, reflections and fogging than the HSL-100 • Aerodynamic shell designed for better fume deflection than the HSL-100 • Smooth, rounded perimeter for increased comfort • Quick and easy replacement of safety plates • Lightweight • Auto On ADF is always ready to weld • Meets ANSI Z87.1 High Impact 2010 standard • CE Certified • DIN Plus Certified • Best-in-Class optical clarity with true 1/1/1/1 rating
37248	—	BH3* DS Internal Safety Plate	100	
37247	—	BH3* DS External Safety Plate	100	
37245	—	BH3* DS Magnification Lens Holder	1	
20696	3014866	370 Replacement Headgear	1	



View with Jackson Safety* ADF Helmet with Balder* Technology



View with competitive ADF

DIGITAL 3-N-1 AUTO-DARKENING FILTERS (ADF)

	NexGen*	NexGen*
Part No.	46148 (HSL 100)	46149 (HLX 100)
Shade	Variable Shade 9-13	Variable Shade 9-13
Light State	4	4
Cartridge Size (in.)	4.53 x 5.30	4.53 x 5.30
Viewing Field (in.)	3.80 x 2.35	3.80 x 2.35
Typical Switching Speed (s)	1/15,000	1/15,000
Lens Power Control	Manual On/Off; Auto Off	Manual On/Off; Auto Off
Grind Mode	Yes	Yes
Torch Mode	Yes	Yes
Sensitivity	Yes	Yes
Delay	Yes	Yes
Arc Sensors	4	4
TIG Rating	< 5 Amps	< 5 Amps
Power Supply	Solar Replaceable Lithium Batteries (2)	Solar Replaceable Lithium Batteries (2)
Estimated Battery Life Max. (hrs.)	823	823
Estimated Battery Life Min. (hrs.)	485	485
Weight Of Helmet (lbs.)	1.55	1.25
Lens Kit	22606	22606
Headgear	20696	20696
Warranty	2 year	2 year



NexGen* Digital Variable ADF Welding Helmet



HSL 100 (Black) with NexGen* ADF

Code	Old Code	Description	Units/Case	Product Features
46148	3002515	HSL 100 Welding Helmet with NexGen* ADF – Black	1	<ul style="list-style-type: none"> • Digital controls feature variable shade 9-13, sensitivity and delay adjustments • Four independent sensors positioned to reduce possibility of blockage during weld • Replaceable lithium batteries (included) with low-battery indicator • Versatile 3-N-1 built-in function: Weld, Torch, Grind • Amber view lens allows for enhanced clarity of weld puddle • Technology allows unit to detect welds less than 5 amps • Built-in mag lens holder • Meets ANSI Z87.1 – 2010 standards and CSA Compliant
15820	3002585	HSL 100 Welding Helmet with NexGen* ADF – Black, Bulk	10	
46149	3013592	HLX 100 Welding Helmet with NexGen* ADF – I ²	1	
46151	3013595	HLX 100 Welding Helmet with NexGen* ADF – Heavy Metal	1	
46152	3023579	HLX 100 Welding Helmet with NexGen* ADF – Arc Angel	1	
24044	3023580	HLX 100 Welding Helmet with NexGen* ADF – Renegade	2	
46154	3023581	HLX 100 Welding Helmet with NexGen* ADF – Ace of Spades	1	
46156	3023582	HLX 100 Welding Helmet with NexGen* ADF – Carbon Fiber	1	
16622	3004384	NexGen* ADF Cartridge	1	
15977	3002670	Replacement Retainer	10	
15984	3002672	Replacement Batteries (Pair) (2450)	10	
15978	3002671	Replacement Battery Door	10	
22606	3020694	NexGen* Lens Kit – 5 Front and 2 Rear Safety Plates	1	
20696	3014866	370 Replacement Headgear	1	



Digital Controls





VARIABLE AUTO-DARKENING FILTERS (ADF)

	Insight* Variable	Nitro* Variable	Element* Variable	SmartIGer* Variable
Part No.	46128	21931	23282	46140
Shade	Variable Shade 9-13	Variable Shade 9-13	Variable Shade 9-13	Variable Shade 9-13
Light State	4	4	4	4
Cartridge Size (in.)	5.25 x 4.5	4.33 x 3.54	3.50 x 4.00	4.33 x 4.33
Viewing Field (in.)	3.94 x 2.36	3.80 x 1.60	3.78 x 1.65	3.78 x 1.81
Typical Switching Speed (s)	1/10,000	1/2,750	1/2,100	1/6,650
Lens Power Control	Auto On/ Auto Off	Auto On/ Auto Off	Auto On/ Auto Off	Auto On/ Auto Off
Grind Mode	Yes	No	No	No
Torch Mode	No	No	No	No
Sensitivity	Yes	Yes	Yes	Yes
Delay	Yes	Yes	Yes	No
Arc Sensors	4	3	2	2
TIG Rating	< 5 Amps	N/A	N/A	< 5 Amps
Power Supply	Replaceable Lithium Batteries	Solar Cell – Non-Replaceable Battery	Solar Cell – Non-Replaceable Battery	Solar Cell – Non-Replaceable Battery
Weight Of Helmet (lbs.)	24 oz.	1.15	1.1	1.2
Lens Kit	41594 (Internal) 41589 (External)	22603	29127	37249 (Internal) 37247 (External)
Headgear	20696	20696	23442	20696
Warranty	2 year	2 year	2 year	5 year

These illustrations demonstrate the distinct difference in ADFs from shade 9 through 13

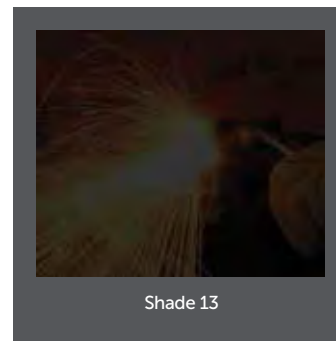
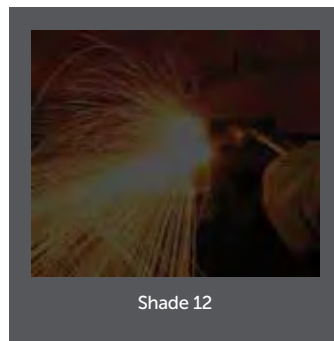
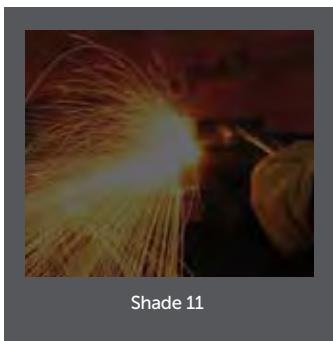
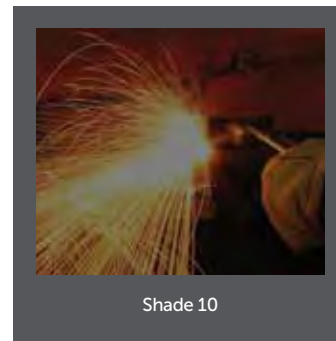
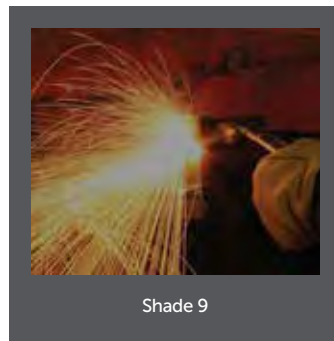
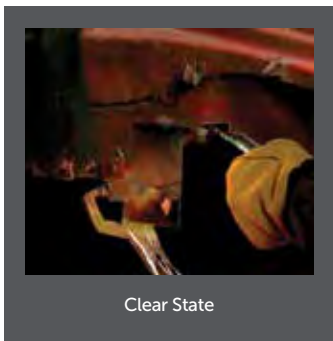



Insight* Digital Variable ADF Welding Helmet



Code	Description	Units/Case	Product Features
46129	HSL 100 Welding Helmet with Insight* Variable ADF — Black	1	<ul style="list-style-type: none"> • Features variable shade 9-13 • Sensitivity and delay adjustments • Compatible with HLX 100 and HSL 100 shell • Meets ANSI Z87.1 – 2010 standards and CSA Compliant • 4 independent sensors • Digital controls
46138	HLX 100 Welding Helmet with Insight* Variable ADF — I ²	1	
46131	HLX 100 Welding Helmet with Insight* Variable ADF — Black	1	
46130	HLX 100 Welding Helmet with Insight* Variable ADF — Arc Angel	1	
46100	HLX 100 Welding Helmet with Insight* Variable ADF — Gold Wings	1	
46101	HLX 100 Welding Helmet with Insight* Variable ADF — Stars & Scars	1	
46109	HLX 100 Welding Helmet with Insight* Variable ADF — Flaming Butterfly	1	
46108	HLX 100 Welding Helmet with Insight* Variable ADF — Metal	1	
46128	Insight* Variable ADF Cartridge	1	
41594	Insight* Clear Internal Safety Plate	10	
41589	Insight* Clear Safety Plate Kit	10	

Nitro* Variable ADF Welding Helmet



Code	Old Code	Description	Units/Case	Product Features
36633	—	Black Nitro* Helmet with Nitro* ADF	2	<ul style="list-style-type: none"> • Offers welders outstanding features at an economical price point • Features variable shade 9-13, sensitivity and delay adjustments • Lightweight – only weighs 1 pound fully assembled • Three independent sensors • Solar-powered • Meets ANSI Z87.1 – 2010 standards and CSA Compliant
21931	3018230	Blue Nitro* Helmet with Nitro* ADF	2	
21947	3018384	Nitro* ADF Cartridge – 90 x 110mm	1	
22603	3020692	Nitro* 3-Sensor Lens Kit – 5 Front and 2 Rear Safety Plates	10	
24549	3024208	Nitro* Replacement Parts – Retainer, Lens Spacer, Screws & Safety Plate	1	
20696	3014866	370 Replacement Headgear	1	



Element* Variable ADF Welding Helmet



Code	Old Code	Description	Units/Case	Product Features
23282	3023293	Element* Welding Helmet Variable ADF – 90 x 110mm	4	<ul style="list-style-type: none"> • Features an economical lens for the consumer welder • Solar-powered • Features variable shade 9-13, sensitivity and delay adjustments • Two independent sensors • Meets ANSI Z87.1 – 2010 standards and CSA Compliant
29127	3023295	Element* Lens Kit – 5 Front and 2 Rear Safety Plates	10	
23442	3023376	Element* Replacement Headgear	6	





SmarTIGer* Variable ADF Welding Helmet with Balder* Technology



Black



Torch Dancer

Code	Old Code	Description	Units/Case	Product Features
46140	—	SmarTIGer* Welding Helmet with Balder* Technology – Black	1	<ul style="list-style-type: none"> • Internal adjustable shade 9-13 • Internal adjustable sensitivity • Aerodynamic shell designed for better fume deflection than the HSL-100 • Lightweight • Auto On ADF is always ready to weld • Meets ANSI Z87.1 High Impact 2010 standard and CE certified
46139	—	SmarTIGer* Welding Helmet with Balder* Technology – Torch Dancer	1	
37245	—	SmarTIGer* Magnification Lens Holder	1	
37249	—	SmarTIGer* Internal Safety Plate	100	
37247	—	SmarTIGer* External Safety Plate	100	
20696	3014866	370 Replacement Headgear	1	



FIXED SHADE AUTO-DARKENING FILTERS (ADF)

	Solera	Element*
Part No.	16376	23286
Shade	Fixed 11 Shade	Fixed 10 Shade
Light State	3	3
Cartridge Size (in.)	4.25 x 2.00	3.50 x 4.33
Viewing Field (in.)	3.60 x 1.40	1.65 x 3.78
Typical Switching Speed (s)	1/1,600	1/1,100
Lens Power Control	Auto On/Auto Off	Auto On/Auto Off
Grind Mode	No	No
Torch Mode	No	No
Sensitivity	No	No
Delay	No	No
Arc Sensors	1	2
Tig Rating	N/A	N/A
Power Supply	Solar Cell – Non-Replaceable Battery	Solar Cell – Non-Replaceable Battery
Estimated Battery Life Max. (hrs.)	N/A	N/A
Estimated Battery Life Min. (hrs.)	N/A	N/A
Weight Of Helmet (lbs.)	1.05	1.1
Lens Kit	24083	23440
Headgear	N/A	23442
Warranty	2 year	2 year

Solera Fixed Shade 11 ADF Welding Helmet



Code	Old Code	Description	Units/Case	Product Features
16376	3004006	Solera ADF Cartridge Fixed Shade 11 – 2 x 4	1	<ul style="list-style-type: none"> • Features an economical lens for the consumer welder • Solar-powered • Fixed shade 11 lens with one centered sensor • Meets ANSI Z87.1 – 2010 standards
24083	3023641	Solera Lens Kit – 5 Front and 2 Rear Safety Plates	1	

Element* Fixed Shade 10 ADF Welding Helmet



Code	Old Code	Description	Units/Case	Product Features
23286	3023294	Element* Welding Helmet – Fixed Shade 10 ADF – 3.50 x 4.33	4	<ul style="list-style-type: none"> • Features an economical lens for the consumer welder • Solar-powered • Fixed shade 10 lens with two independent sensors • Meets ANSI Z87.1 – 2010 standards, CSA Compliant and CE Certified
23440	3023375	Element* Lens Kit – 5 Front and 2 Rear Safety Plates	10	
23442	3023376	Element* Replacement Headgear	6	





SPECIALTY WELDING HELMETS

860P Leather Welding Helmet



Code	Old Code	Description	Units/Case	Product Features
14531	3000506	860P Leather Welding Helmet – 2 x 4.25 Lift Front, Black	4	<ul style="list-style-type: none"> • Features a tough yet pliable leather covering • Ideal for use in overhead welding applications or when working in tight spaces • 14531 meets ANSI Z87.1 – 2010 standards and CSA Compliant
26035	3000507	860P-2 Leather Welding Helmet – 2 x 4.25 Lift Front	1	
16073	3002759	Replacement Safety Plate – 2 x 4.25	25	
14556	3000621	117A Replacement Headgear	6	
24557	3024222	860P Parts Kit	1	

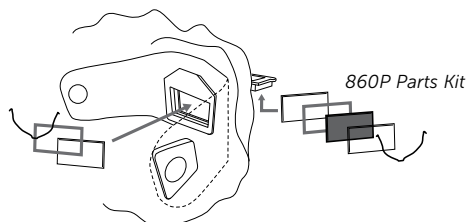

430P Fiber Shell Welding Helmet



Code	Old Code	Description	Units/Case	Product Features
14528	3000499	430P Fiber Shell Welding Helmet – 2 x 4.25 Lift Front	4	<ul style="list-style-type: none"> • Features a lightweight vulcanized fiber shell for comfortable yet cool, heavy-duty welding • Made of 10% recycled fiber content • Not suited for damp environments or overhead welding • Lift front provides flexibility so user does not have to raise hood • Meets ANSI Z87.1 – 2010 standards
16073	3002759	Replacement Safety Plate – 2 x 4.25	25	
14556	3000621	117A Replacement Headgear	6	
24528	3024139	430P Parts Kit	1	

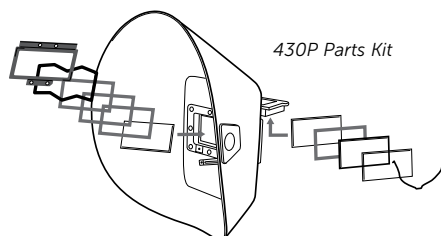

490P Fiber Shell Welding Helmet



Code	Old Code	Description	Units/Case	Product Features
14532	3000509	490P Fiber Shell Welding Helmet – 2 x 4.25 Quick Slide	4	<ul style="list-style-type: none"> • Features a lightweight vulcanized fiber shell for comfortable yet cool, heavy-duty welding • Made of 10% recycled fiber content • Not suited for damp environments or overhead welding • Quick-slide filter plate holder is ideal for tight work environments • Meets ANSI Z87.1 – 2010 standards
16073	3002759	Replacement Safety Plate – 2 x 4.25	25	
14556	3000621	117A Replacement Headgear	6	
24551	3024210	490P Parts Kit	1	

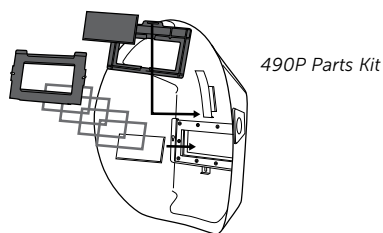

411P Fiber Shell Welding Helmet

MTO



Code	Old Code	Description	Units/Case	MTO
14527	3000496	411P Fiber Shell Welding Helmet – 2 x 4.25	4	
16073	3002759	Replacement Safety Plate – 2 x 4.25	25	
14556	3000621	117A Replacement Headgear	6	
24530	3024141	411P Parts Kit	1	

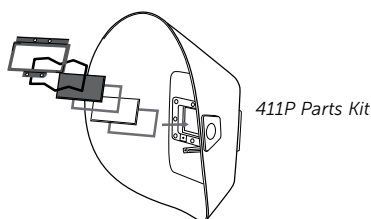

- Product Features**
- Features a lightweight vulcanized fiber shell for comfortable yet cool, heavy-duty welding
 - Made of 10% recycled fiber content
 - Not suited for damp environments or overhead welding
 - Fixed front with aluminum frame filter plate holder
 - Meets ANSI Z87.1 – 2010 standards

451P Fiber Shell Welding Helmet

MTO



Code	Old Code	Description	Units/Case	MTO
14529	3000500	451P Fiber Shell Welding Helmet – 4.5 x 5.25	4	
16078	3002760	Replacement Safety Plate – 4.5 x 5.25	25	
14556	3000621	117A Replacement Headgear	6	
24565	3024236	451P Parts Kit	1	■

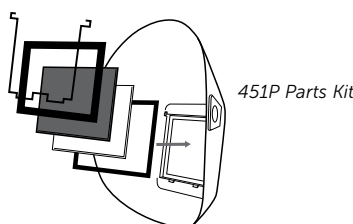

- Product Features**
- Features a lightweight vulcanized fiber shell for comfortable yet cool, heavy-duty welding
 - Made of 10% recycled fiber content
 - Not suited for damp environments or overhead welding
 - Meets ANSI Z87.1 – 2010 standards

PASSIVE WELDING HELMETS

HSL 1 Passive Welding Helmet

MTO



Code	Old Code	Description	Units/Case	MTO
14979	3002503	HSL 1 Passive Welding Helmet Black – 2 x 4.25	4	
15121	3002579	HSL 1 Passive Welding Helmet Black – 2 x 4.25 (Bulk)	10	■
16073	3002759	Replacement Safety Plate – 2 x 4.25	25	
20696	3014866	370 Replacement Headgear	1	

- Product Features**
- Narrow shell design is perfect for work in tight spaces
 - Extended front increases throat protection from sparks and slag and other physical hazards
 - Hard hat adaptable using 187-S (15968)
 - Meets ANSI Z87.1 – 2010 standards and CSA Compliant



HSL 2 Passive Welding Helmet – Lift Front

MTO



Code	Old Code	Description	Units/Case	MTO	Product Features
14982	3002507	HSL 2 Passive Welding Helmet Black – 2 x 4.25 Lift Front	4		• Narrow shell design is perfect for work in tight spaces
15132	3002580	HSL 2 Passive Welding Helmet Black – 2 x 4.25 Lift Front (Bulk)	10		• Extended front increases throat protection from sparks, slag and other physical hazards
14986	3002512	HSL 2 Passive Welding Helmet Black with 187 Blades – 2 x 4.25 Lift Front	4		• Hard hat adaptable using 187-S (15968)
14972	3002490	HSL 2 Passive Welding Helmet Black with 386 Cap Adapter – 2 x 4.25 Lift Front	4	■	• Meets ANSI Z87.1 – 2010 standards and CSA Compliant
16073	3002759	Replacement Safety Plate – 2 x 4.25	25		
20696	3014866	370 Replacement Headgear	1		
24523	3024132	HSL 2 Parts Kit	1		

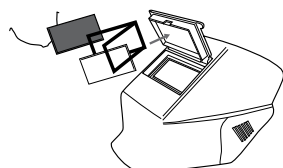

HSL 2 Parts Kit



MTD

HSL 100 Passive Welding Helmet

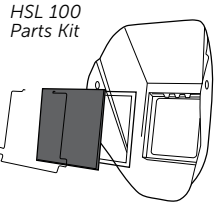

HSL 100
Parts Kit

Code	Old Code	Description	Units/Case	MTD	Product Features
14975	3002498	HSL 100 Passive Welding Helmet Black – 4.5 x 5.25	4		
15134	3002581	HSL 100 Passive Welding Helmet Black – 4.5 x 5.25 (Bulk)	10		• Narrow shell design is perfect for work in tight spaces
14978	3002502	HSL 100 Passive Welding Helmet Black with 187 Blades – 4.5 x 5.25	4		• Extended front increases throat protection from sparks, slag and other physical hazards
14973	3002491	HSL 100 Passive Welding Helmet Black with 386 Cap Adapter – 4.5 x 5.25	4		• Hard hat adaptable using 187-S (15968)
16642	3004736	Replacement Light Leak Gasket	2		• ADF adaptable - NexGen*
16078	3002760	Replacement Safety Plate – 4.5 x 5.25	25		- Insight*
20696	3014866	370 Replacement Headgear	1		• Meets ANSI Z87.1 – 2010 standards, CSA Compliant
24550	3024209	HSL 100 Parts Kit	1		
15974	3002647	Magnifier (Cheater Lens) Adapter	12		



HLX 100 Passive Welding Helmet – Ultra Lightweight



Carbon Fiber

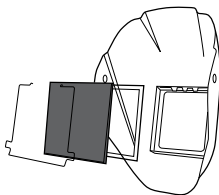

Halo X Parts Kit

Code	Old Code	Description	Units/Case	Product Features
20508	3013597	HLX 100 Passive Welding Helmet – Heavy Metal – 4.5 x 5.25	2	• Ultra lightweight shell – only weighs 6 ounces
24737	3024543	HLX 100 Passive Welding Helmet – Carbon Fiber – 4.5 x 5.25	2	• Lightweight shell helps reduce neck tension
34068	—	HLX 100 Passive Welding Helmet – Black – 4.5 x 5.25	2	• Hydrflex* Shell provides the ultimate in flexibility and durability
16078	3002760	Replacement Safety Plate – 4.5 x 5.25	25	• Hard hat adaptable using 187-S (15968)
20696	3014866	370 Replacement Headgear	1	• ADF adaptable - NexGen*
24550	3024209	Halo X Parts Kit	1	- TrueSight* II - Insight*
15974	3002647	Magnifier (Cheater Lens) Adapter	12	• Meets ANSI Z87.1 – 2010 standards and CSA Compliant



Heavy Metal



Black

951P Passive Welding Helmet



Code	Old Code	Description	Units/Case	Product Features
14535	3000512	951P Passive Welding Helmet – 4.5 x 5.25	4	<ul style="list-style-type: none"> • Lightweight, durable, washable thermoplastic shell • Meets ANSI Z87.1 – 2010 standards and CSA Compliant
16078	3002760	Replacement Safety Plate – 4.5 x 5.25	25	
14556	3000621	117A Replacement Headgear	6	
15974	3002647	Magnifier (Cheater Lens) Adapter	12	
24548	3024206	951P Parts Kit	1	

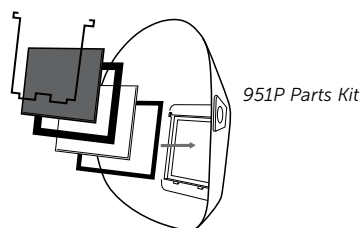

990P Passive Welding Helmet



Code	Old Code	Description	Units/Case	Product Features
14536	3000514	990P Passive Welding Helmet – 2 x 4.25 Quick Slide	4	<ul style="list-style-type: none"> • Lightweight, durable washable thermoplastic shell • Quick slide adjustment conveniently switches from clear to shade #10 • Meets ANSI Z87.1 – 2010 standards
16073	3002759	Replacement Safety Plate – 2 x 4.25	25	
14556	3000621	117A Replacement Headgear	6	
24551	3024210	990P Parts Kit	1	

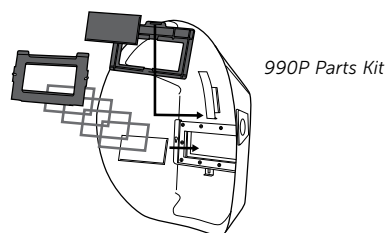

930P Passive Welding Helmet



Code	Old Code	Description	Units/Case	Product Features
14534	3000511	930P Passive Welding Helmet – 2 x 4.25 Lift Front	4	<ul style="list-style-type: none"> • Lightweight, durable washable thermoplastic shell • Lift front filter eliminates need to raise welding helmet • Meets ANSI Z87.1 – 2010 standards
16073	3002759	Replacement Safety Plate – 2 x 4.25	25	
14556	3000621	117A Replacement Headgear	6	
24528	3024139	930P Parts Kit	1	

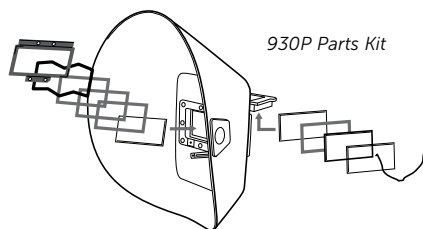



POWERED AIR PURIFYING RESPIRATOR (PAPR)

Airmax Elite* Powered Air Purifying Respirator (PAPR)

Code No.	Description	Product Features
40839	Airmax Elite* PAPR with BH3* Air Headtop	<ul style="list-style-type: none"> BH3* Air Welding Helmet features variable auto-darkening filter with Balder* Technology. This technology provides superior optical viewing clarity from any angle along with one of the largest ADF viewing areas of 3.78" x 2.70" Variable ADF with grind mode. Adjustable shades 6-8 (grind) and 9-13 via external knob Flame-retardant face seal around welding helmet protects against sparks Lightweight blower with advanced control system to maintain constant airflow rate throughout the charge of the battery Audible and vibrating alarms signal welder when need for new filter or battery change. Blower unit display also provides visual status of the battery charge and level of filter clogging Three-layer filter provides NIOSH-approved HE filtration from particulate contaminants. The pre-filter extends the operating life of the main filter by capturing coarse particles. The spark arrester helps protect the main filter from damage by sparks and welding spatter Breathing Hose with flame-retardant cover is protected against sparks and flexes with the welder during use Rechargeable lithium ion battery is the newest battery technology that provides 8 hours of power "Smart" Battery Charger indicates when charging and when complete without overcharging the battery Adjustable belt accommodates personal sizing from 25" to 62"
REPLACEMENT PARTS		
40840	Airmax Elite* BH3* Air Headtop complete with storage bag	
40880	Airmax Elite* Blower Unit Kit (blower unit, belt, breathing hose, airflow indicator, battery and charger)	
40885	BH3* Air Grand GDS ADF	
40884	BH3* Air Helmet Shell (includes cover plates and Flexi Face Seal)	
40887	BH3* Air Flexi Face Seal (2 pack)	
40882	BH3* Air 375 Headgear	
40881	BH3* Air Sweatband (2 pack)	
40879	Airmax Elite* Blower Unit (no battery)	
40878	Airmax Elite* HE Filter (6 pack)	
40876	Airmax Elite* Filter Cover and Spark Arrester Mesh (2 pack)	
40877	Airmax Elite* Pre-Filter (10 pack)	
40864	Airmax Elite* Lithium Ion Battery	
40863	Airmax Elite* Battery Charger	
40846	Airmax Elite* Breathing Hose with Flame-Retardant Cover	
40841	Airmax Elite* Waist Belt	
41345	Airmax Elite* Airflow Indicator	

Product Code	Lens	Filter	Initial Flow Rate	Actual Flow Rate	Battery Life	Charging Time	Charges	Alarms	Certification	Blower Dimensions	Weight
40839	Variable ADF with grind mode: • Shades 9-13 cut/weld • Shades 6-8 grind	HE	Meets the NIOSH minimum flow rate of >170 LPM / 6+ CFM	200/240	Lithium Ion 8 Hours	< 4 hours	Maintains 300 charges of power	Audible and Vibration	NIOSH 42 CFR Part 84	L: 9.0" W: 5.0" H: 2.5"	3.2 lb (blower, filter, breathing hose, battery) 1.8 lb (helmet)



WELDING ACCESSORIES

187-S Mounting Kit



Code	Old Code	Description	Units/Case	Product Features	
15968	3002634	187-S Mounting Kit	12	<ul style="list-style-type: none"> Securely attaches a welding helmet to safety cap Positive locking device keeps the helmet in any position 	
187-S Can Be Used With		SC-6	Sentry III*	Charger*	SC-16
HLX Series		●	●	●	●
HSL Series Shadow		●	●	●	●
Nitro*		●	●	●	●

87 Mounting Blades



Code	Old Code	Description	Units/Case	Product Features	
14939	3002435	87 Mounting Blades, Pair	12	<ul style="list-style-type: none"> Attaches almost any H-Series welding helmet safely and securely to a hard hat Must use with metal 86-M Quick Detach Pins (sold separately) 	
14961	3002462	86-M Quick Detach Metal Pins, Pair	50		
87 Blades Can Be Used With		SC-6	Sentry III*	Charger*	SC-16
H Series					●

386 Capmount Adapter



Code	Old Code	Description	Units/Case	Product Features	
15973	3002645	386 Capmount Adapter	12	<ul style="list-style-type: none"> Lets you attach any H-Series fiberglass or HSL welding helmet safely and securely to a hard hat 	
386 Adapter Can Be Used With		SC-6	Sentry III*	Charger*	SC-16
HSL Series		●			
HSL Series Shadow		●			
Nitro*		●			

REPLACEMENT HEADGEAR

370 Headgear



Code	Old Code	Description	Units/Case
20696	3014866	370 Headgear	1
32187		Replacement Sweatband	2 packs of 24

370 Replacement Headgear for:

HSL-1	Nitro*	NexGen*	BH3*
HSL-2			TrueSight* II
HSL-100	SmarTIGer*		

Product Features

- Three-position slider adjusts distance of the lens from your eyes for precise vision
- Removable Comfort Cradle is a pivoting headpad that conforms to any head for the highest degree of comfort
- Oversized ratchet with soft rubber grip allows for easy adjustment when wearing gloves
- Crown Strap Adjustment allows the headgear to be raised or lowered for maximum comfort and performance
- Sweatband helps absorb perspiration and prevents sweat from interfering with vision
- Vertical lock-in eliminates helmet creeping
- Lock-nut feature keeps the components together even when bracket is loosened

117A Headgear



Code	Old Code	Description	Units/Case
14556	3000621	117A Headgear	6
32187		Replacement Sweatband	2 packs of 24

117A Replacement Headgear for:

951P	860P
990P	430P
930P	490P
	411P
	451P

Product Features

- Teeth are automatically disengaged during adjustment
- Air-cushioned cloth sweatband is washable and durable

170 Headgear



Code	Old Code	Description	Units/Case
14956	3002454	170 Headgear	12
14958	3002459	Replacement Sweatband	12

170 Replacement Headgear for:

H100-A

Product Features

- 170 features 45 head size adjustments and 5 crown adjustments
- Lower ratchet strap for added comfort and strength
- Ratchet eliminates "backing off" with push and turn design
- For use with H-Series fiberglass helmets

Element* Replacement Headgear



Code	Old Code	Description	Units/Case
23442	3023376	Element* Replacement Headgear	6

Element* Replacement Headgear for:

Element* Shade 10	Element* Variable
----------------------	----------------------

Product Features

- Teeth are automatically disengaged during adjustment

FILTERS

Kimberly-Clark Professional has a large selection of top-quality polycarbonate lenses for welding helmets and cutting goggles.*



To prevent surface damage to welding filter plates and auto-darkening lenses, clear safety plates should always be inserted in front for protection. Be sure to use the correct filter shade for the job. Refer to the suggested shade guide below.

BH3*	TrueSight* II	NexGen*	SmarTIGer*	Nitro* 3-Sensor	Element* Variable	Solera	Element* Shade 10
Kit includes: 5 Front Clear Safety Plates, 2 Inner Clear Safety Plates, 1 Light Seal Gasket							
N/A	N/A	22606	N/A	22603	29127	24083	23440
Internal Lens – Sold Separately							
37248	30321	30590	37249	30594	N/A	16073	N/A
External Lens – Sold Separately							
37247	30320	16078	37247	20755	N/A	16073	N/A

Series Passive Filter Lens

Code	Old Code	Description	Size	Material	Units/Case
14571	3000691	427 Filter Lens Sh. 5	2" x 4.25"	Polycarbonate	25
14559	3000644	427 Filter Lens Sh. 9	2" x 4.25"	Polycarbonate	25
14560	3000645	427 Filter Lens Sh. 10	2" x 4.25"	Polycarbonate	25
14570	3000690	427 Filter Lens Sh. 11	2" x 4.25"	Polycarbonate	25
14562	3000649	1127 Filter Lens Sh. 9	4.5" x 5.25"	Polycarbonate	25
14563	3000650	1127 Filter Lens Sh. 10	4.5" x 5.25"	Polycarbonate	25
14564	3000651	1127 Filter Lens Sh. 11	4.5" x 5.25"	Polycarbonate	25
14566	3000652	1127 Filter Lens Sh. 12	4.5" x 5.25"	Polycarbonate	25

Safety Plates & Components

Code	Old Code	Description	Size	Material	Units/Case
16073	3002759	54 PC	2" x 4.25"	Polycarbonate	25 per Pack
16078	3002760	97 PC	4.5" x 5.25"	Polycarbonate	25 per Pack
16642	3004736	Light Seal Gasket	4.5" x 5.25"	Polycarbonate	25 per Pack
24734	3024540	Light Seal Gasket Inserted on Safety Plate	4.5" x 5.25"	Polycarbonate	10 per Pack



Kimberly-Clark Professional* offers a wide selection of Mag Plates to fit the needs of most welders.

While providing close vision without glasses, the 2x4 Mag Plates are also adaptable to all Auto-Darkening Filters. Select focal power by comparing prescription lenses.



Mag Plates

Code	Old Code	Focal Power	Units/Case
16052	3002741	1.00	6
16054	3002742	1.25	6
16058	3002743	1.50	6
16060	3002744	1.75	6
16063	3002745	2.00	6
16065	3002746	2.25	6
16068	3002747	2.50	6

Adapter Kits





Code	Old Code	Description
15974	3002647	4.50 x 5.25 Mag Lens Holder
37245	—	BH3* and SmarTIGer* Mag Lens Holder

Compatibility Chart

SHELL	HALO X	HSL-100	HSL-1	HSL-2	951P	990P	930P	860P	H100-A	430P	490P	411P	451P	Element*	Nitro*
Cap Adapter 	187-S	187-S	187-S	187-S											187-S
	386	386	386	386					87 M Blades						386
Headgear 	370	370	370	370	117A	117A	117A	117A	170	117A	117A	117A	117A	Element*	370
	TrueSight* II NexGen*	NexGen*													
	Insight*	Insight*												Element* Variable	Nitro*
			Solera											Element*	

ELECTRIC LINE

Electrode Holders

	Code	Old Code	Description	Body Alloy	Electrode Capacity	Cable Connection Capacity	Weight	Duty Cycle Rating	Units/Case
	14679	3001793	JH-1	Copper Alloy	3/16 inch	4 through 1/0	12 ounces	Medium Duty	24
	14683	3001797	JH-2	Aluminum Alloy	5/32 inch	4 through 1/0	10 ounces	Light Duty	24
	14680	3001794	AW-C	Copper Alloy	1/4 inch	4 through 2/0	19 ounces	Medium Duty	24
	14682	3001796	A-W	Aluminum Alloy	1/4 inch	3 through 2/0	14 ounces	Medium Duty	24
	14681	3001795	A3-S	Copper Alloy	3/8 inch	2/0 through 4/0	30 ounces	Heavy Duty	12
	14684	3001798	J-4	—	1/4 inch	2 through 1/0	16 ounces	Heavy Duty	12



Duty Cycle Rating is the maximum percentage of arc time (out of any 10-minute period) that a holder should be expected to perform comfortably.

Replacement parts available — email mykcporders@kcc.com

Cable Connectors

Kimberly-Clark Professional* offers a popular range of fully insulated cable connectors with tapered ends covering the cable jacket and locking out moisture, oil and dirt.

Cable Connectors

Code	Old Code	Description	Cable Connection Type	Connection Half Connection Type	Cable Connection Capacity	Standard Pack	Units/Case
14741	3001848	Uni-Trik* UB-1-BP	Double Dome-Nose	Camlock	4 through 1	1 each Male & Female	6
14742	3001849	Uni-Trik* UB-3-BP	Double Dome-Nose	Camlock	1/0 through 3/0	1 each Male & Female	6
14745	3001852	Uni-Trik* UB-4-BP	Double Dome-Nose	Camlock	3/0 through 4/0	1 each Male & Female	6
14733	3001840	Quick-Trik* QNB-2-BP	Single Dome-Nose	Camlock & Locking Bar	1/0 and 2/0	1 each Male & Female	6
14734	3001841	Quick-Trik* QNB-4-BP	Single Dome-Nose	Camlock & Locking Bar	3/0 and 4/0	1 each Male & Female	6
14735	3001842	Quick-Trik* QB-2-BP	Single Dome-Nose	Camlock & Locking Bar	1/0 and 2/0	1 each Male & Female	6

Uni-Trik*

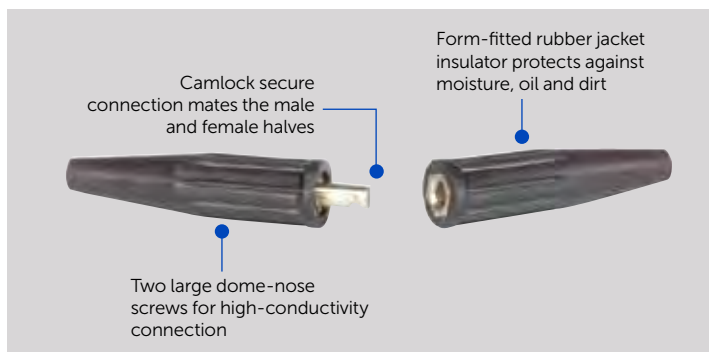

Quick-Trik*

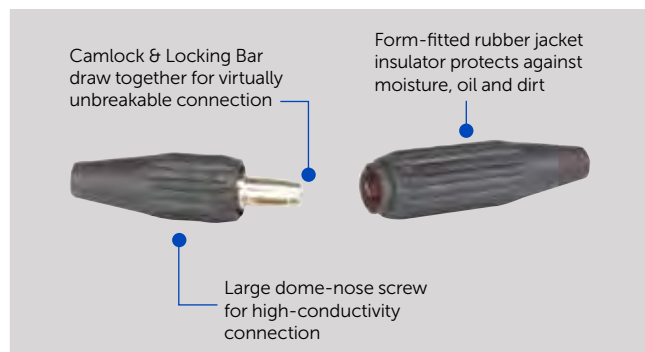

Ground Clamps

Jackson Safety* Brand Ground Clamps feature large contact areas, high-clamping pressure and long-levered handles for easy jaw opening. Clamps have fully insulated pivots and springs. The cable jacket is held securely inside the conductor body with a cable bar for improved holding ability and longer cable life.

Ground Clamps

Code	Old Code	Description	Jaw Opening	Cable Connection Cap.	Weight	Std. Pack
14730	3001834	GC-2	1¼ inch	4 through 1/0	16 oz.	24
14731	3001835	GC-3	1½ inch	1/0 and 2/0	23 oz.	24
14732	3001836	GC-5	2 inch	3/0 and 4/0	34 oz.	12

Cable Lugs and Terminal Covers

Code	Old Code	Description	Standard Pack
14748	3001855	Cable Lug QLB-45	Sold in pairs
14747	3001854	Cable Lug ULB-45	Sold in pairs
14746	3001853	Terminal Covers	Sold in pairs

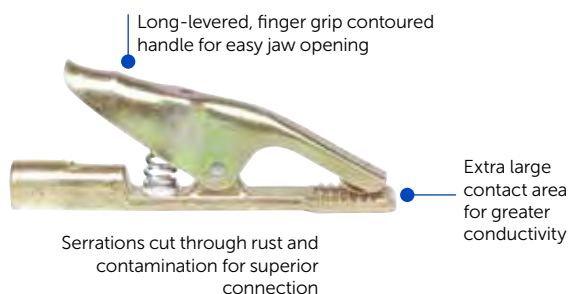

CONTOUR LAYOUT SYSTEMS

Cylindrical Pipe Markers

	Code	Old Code	Description	Pipe Diameter
	14771	3001874	#1 Contour Marker	1½" to 18" diameter
	14772	3001875	#2 Contour Marker Combo Adaptor	Use with #1 Contour Marker
	14773	3001877	#4 Jumbo Contour Marker	8" to 48" diameter
	14774	3001878	#5 Jumbo Marker Combo Adaptor	Use with #4 Contour Marker
	14784	3001888	#14 Circle-Ellipse Projector	1½" to 18" diameter
	14775	3001879	#6 Centering Head	½" to 4" diameter
	14797	—	Contour Dial-Set-Level (DSL)	Adjustable bubble protractor
	14780	3001884	Radius Marker – Mini	Up to 8" in radius
	14781	3001885	Radius Marker – Small	Up to 20" in radius
	14782	3001886	Radius Marker – Standard	Up to 24" in radius
	14783	3001887	Radius Marker – Jumbo	Up to 40" in radius
	14785	3001890	#19 Multi-Trammel Heads	All
	14778	3001882	#9 Fitter Welding Protractor	All

Flange Aligning Tools



Code	Old Code	Description
14779	3001883	#10 Pipe Flange Aligner
14795	3001903	#32 Flange Aligner Base
14796	3001904	#33 Universal Level
14777	3001881	#8 Pro-Mag Level
14786	3001891	#20 Dual-Angle Flange Level – Nonmagnetic, can be used on PVC Pipe

Pre-Assembled Kits



Code	Old Code	Description
20664	3014807	Contour Worker Kit <ul style="list-style-type: none"> • #1 Contour Marker • #7 Centering Head • #8 Pro-Mag Level • Standard Radius Marker • Square Soap Stone & Holder • Lockable Metal Carrying Case

Burning Square & Guides



Code	Old Code	Description
14791	3001899	#28 Magnetic Burning Guide
14792	3001900	#29 – 34" Extension (Use with #28 Magnetic Burning Guide)
14793	3001901	#30 – 48" Extension (Use with #28 Magnetic Burning Guide)
14794	3001902	#31 – 72" Extension (Use with #28 Magnetic Burning Guide)

Wrap-A-Round* Tools

Code	Old Code	Description	Color	Size	Pipe Diameter
14752	3001858	Medium Wrap-A-Round*	Black	3.88" to 4'	3" to 6"
14763	3001867	Medium Wrap-A-Round*	Gray	3.88" to 4'	3" to 6"
14753	3001859	Large Wrap-A-Round*	Black	3.88" to 6'	3" to 10"
14764	3001868	Large Wrap-A-Round*	Gray	3.88" to 6'	3" to 10"
14754	3001860	X-Large Wrap-A-Round*	Black	5" to 7'	4" to 12"
14766	3001869	X-Large Wrap-A-Round*	Gray	5" to 7'	4" to 12"
14756	3001861	XX-Large Wrap-A-Round*	Black	5" to 9'	6" to 16"
14767	3001870	XX-Large Wrap-A-Round*	Gray	5" to 9'	6" to 16"



WILSON* WELDING CURTAINS AND HIGH-TEMPERATURE FABRICS

Kimberly-Clark Professional has focused our Wilson* product line to offer the best assortment of curtains, blankets and accessories to meet your needs.*

All Wilson* products are electronically welded or sewn for superior quality and long-lasting protection.

The Wilson* Brand has made significant contributions to advancing industrial barrier protection since the 1950s. It's the brand recognized for originating the first transparent form of barrier welding protection, and we're pleased to feature Wilson* in our trusted line of safety products.

WELDING CURTAINS

Wilson* Welding Curtains and Screens are designed to address the challenges of employee safety and workplace productivity relative to a wide range of high-heat applications. Actual finished size on standard orders may vary 3" in height and width.

All Wilson* Welding Curtains meet or exceed California State Fire Marshall (CFM) requirements for flame resistance. **These fabrics are not intended for use in lieu of visors, goggles, eyewear or welding helmets. Clear/colorless See-Thru Curtains available in 14-Mil are not intended for welding or ultraviolet filtration.**

- Transparent curtains feature secure side hemming done by an electronic welding process for added strength and durability
- Plastic grommets are placed 8" apart on one width side and 16" apart on both height sides providing improved wear and less possibility of separation
- Standard sizes and roll goods are available





SEE-THRU WELDING CURTAINS

Wilson* Orange 14-Mil See-Through Welding Curtain

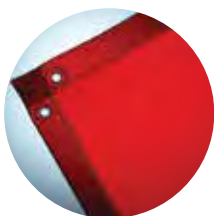

Code	Old Code	Description	Product Features
37606	6424-25	6' x 4' See-Through Orange Curtain	<ul style="list-style-type: none"> • Heavy-duty vinyl designed to filter far/near ultraviolet radiation and blue light • Grommeted and ready-to-hang (tubing or framing not included)
36292	6636-25	6' x 6' See-Through Orange Curtain	
36307	6848-25	6' x 8' See-Through Orange Curtain	
36278	61060-25	6' x 10' See-Through Orange Curtain	
36287	61272-25	6' x 12' See-Through Orange Curtain	

Wilson* Gold 14-Mil See-Through Welding Curtain

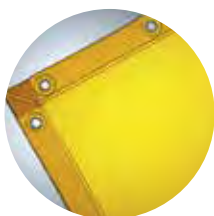

Code	Old Code	Description	Product Features
37607	6424-50	6' x 4' See-Through Gold Curtain	<ul style="list-style-type: none"> • Heavy-duty vinyl designed to filter far/near ultraviolet radiation and blue light • Grommeted and ready-to-hang (tubing or framing not included)
36296	6636-50	6' x 6' See-Through Gold Curtain	
36312	6848-50	6' x 8' See-Through Gold Curtain	
36281	61060-50	6' x 10' See-Through Gold Curtain	

Wilson* Green 14-Mil See-Through Welding Curtain



Code	Old Code	Description	Product Features
37700	6424-60	6' x 4' Green See-Through Curtain	<ul style="list-style-type: none"> • Heavy-duty vinyl designed to filter far/near ultraviolet radiation and blue light • Grommeted and ready-to-hang (tubing or framing not included)
36299	6636-60	6' x 6' Green See-Through Curtain	
36315	6848-60	6' x 8' Green See-Through Curtain	
36283	61060-60	6' x 10' Green See-Through Curtain	

WELDING/ SAFETY SCREENS



Wilson* Stur-D-Screen¹

- Allows for a variety of configurations to fit multiple work environments
- Square 19-gauge steel tubing, bolted corner clamps and platform "T" legs reduce slipping and twisting of the unit
- Black powder-coated enamel finish is rust- and abrasion-resistant
- Package includes square steel frame, brackets, platform "T" legs, and lacing ties
- Pre-drilled for casters

Wilson* Stur-D-Screen¹ and recommended curtains with each frame size

Frame Only		Frame Size	See-Thru Orange	See-Thru Gold	See-Thru Green
36335	R1064-00	6' x 4' Single Panel	37606	37607	37700
36336	R1066-00	6' x 6' Single Panel	36292	36296	36299
36338	R1068-00	6' x 8' Single Panel	36307	36312	36315
36333	R10610-00	6' x 10' Single Panel	36278	36281	36823

Per OSHA recommendations, allow 1' clearance at floor for all framing configurations.

¹ Temperatures and applications are intended as a guideline only and not a guarantee of performance. Kimberly-Clark Professional* recommends the use of welding blankets in multiple layers to attain proper molten-metal and radiant-heat protection. It is the user's responsibility to monitor the activity and use of blankets/high-heat roll goods at all times.

HIGH-TEMPERATURE FABRICS

Wilson* High-Temperature Fabrics protect equipment and employees working near hazardous operations such as flame cutting, welding, grinding and spraying. Available as blankets, hanging curtains or roll goods, Wilson* Fabrics are designed to withstand temperatures ranging from 600°F–2000°F.² All high-temperature fabrics meet minimum specification standards for flame resistance (NFPA-701). Welding blankets are hemmed on all four sides using durable, heat-resistant thread and feature grommets in each corner and on 36" centers.

HIGH-HEAT MATERIAL RECOMMENDATIONS

Temperature ratings are based on recommended uses and information provided herein is intended as a guideline only. Kimberly-Clark Professional* recommends the use of welding blankets in multiple layers to attain proper molten-metal and radiant-heat protection. It is the user's responsibility to monitor the activity and use of all blankets and roll goods at all times.



CHOOSING THE RIGHT HIGH-HEAT MATERIAL

APPLICATIONS	MATERIALS			
	15-oz Acrylic Coated (3001)	16-oz Polyurethane Coated (2000TP)	24-oz Vermiculite Coated (906)	32-oz Silicone Coated (3000R)
Welding Vertical – general-purpose welding with light sparks & spatter	●	●	●	●
Grinding & Flame Cutting	●	●	●	●
Furnace Blanket				
Slag Protection	●	●	●	●
Welding Horizontal – use as blanket				●

² Temperatures and applications are intended as a guideline only and not a guarantee of performance. Kimberly-Clark Professional* recommends the use of welding blankets in multiple layers to attain proper molten-metal and radiant-heat protection. It is the user's responsibility to monitor the activity and use of blankets/high-heat roll goods at all times.



All Wilson Blankets listed are FM-Approved

LIGHT-USE PROTECTION

Wilson* Weld-O-Glass 15-oz Fiberglass Blanket, Acrylic Coated

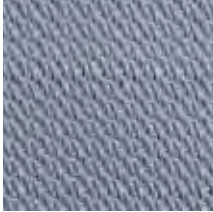

Code	Old Code	Description
37192	1010100-3001	10' x 10' 15-oz Fiberglass Blanket, Acrylic Coated

Product Features

- **ANSI/ FM-4950** certified for use in vertical applications (1.4.3) with light-moderate exposures resulting from chipping, grinding, heat treating, sand blasting and light horizontal welding; prevents sparks from escaping from a confined area
- Color: Gray

Wilson* Weld-O-Glass 16-oz Fiberglass Blanket, Polyurethane Coated



Code	Old Code	Description
36148	2000TP-38	Roll Goods, 38" x 50 yards
36149	2000TP-60	Roll Goods, 60" x 50 yards

Product Features

- **ANSI/ FM-4950** certified for use in vertical applications (1.4.3) with light-moderate exposures resulting from chipping, grinding, heat treating, sand blasting and light horizontal welding; prevents sparks from escaping from a confined area
- Roll goods sold in 50-yard increments: minimum order is 1 roll or 50 yards
- Color: Red

MEDIUM- TO HEAVY-USE PROTECTION

Wilson* Weld-O-Glass 24-oz Fiberglass Blanket, Vermiculite Coated



Code	Old Code	Description
36217	5525-906	5' x 5' Fiberglass Blanket, Vermiculite Coated
36302	6636-906	6' x 6' Fiberglass Blanket, Vermiculite Coated
36318	6848-906	6' x 8' Fiberglass Blanket, Vermiculite Coated

Product Features

- **ANSI/ FM-4950** certified for use in vertical applications (1.4.3) with light-moderate exposures resulting from chipping, grinding, heat treating, sand blasting and light horizontal welding; prevents sparks from escaping from a confined area
- Color: Black

HEAVY-DUTY PROTECTION

Wilson* Weld-O-Glass 32-oz Fiberglass Blanket, Silicone Coated



Code	Old Code	Description
37592	1010100-3000R	10' x 10' Fiberglass Blanket, Silicone Coated

Product Features

- **ANSI /FM-4950** certified for use in horizontal applications with light-moderate exposures resulting from chipping, grinding, heat treating, sand blasting and light horizontal welding; protects machinery and prevents ignition of combustibles such as wood that are located adjacent to the underside of the blanket.
- Color: Red



ACCESSORIES

Welding Curtain Hooks



Code	Old Code	Description	Quantity
36687	WIL100	Heavy-duty hooks for use with welding curtains. Fit 1-1/2" - 2" outside diameter pipe	10/pack (No pack splits)

Our Guarantee

Your total satisfaction means everything to us. If, for any reason, our products do not meet your expectations, Kimberly-Clark will reimburse you[†] for your initial purchase, via FREE product, for up to \$1,000. For more information on Kimberly-Clark Professional*, visit us online at www.KCProfessional.com.

‡ Guarantee extended to consuming end-user accounts only.

Kimberly-Clark warrants that its products (1) comply with K-C's standard specifications as of the delivery date to K-C's authorized distributors/direct purchasers and are warranted for the following periods from end-user's date of purchase (verified by valid sales receipt) (a) five years for Balder* Technology auto darkening filters; (b) two years for all other auto-darkening filters; and (c) one year for powered air-purifying respirators; (2) comply with all K-C labeling representations; and (3) are manufactured in compliance with all applicable federal, state, and local laws in effect at the time and place of manufacture of the products. THIS WARRANTY IS IN LIEU OF ALL OTHER WARRANTIES, EXPRESS OR IMPLIED, INCLUDING ANY WARRANTY OF MERCHANTABILITY OR FITNESS FOR A PARTICULAR PURPOSE. K-C is not liable for any kind of special, incidental, or consequential damages. K-C's liability for breach of contract, tort or other cause of action shall not exceed the product purchase price. Purchasers and users are deemed to have accepted the above warranty and limitation of liability, and cannot change the terms by verbal agreement or by any writing not signed by K-C. To the extent required by applicable law, K-C does not limit its liability for death/injury resulting from K-C's negligence.

© Registered Trademark or * Trademark of Kimberly-Clark Worldwide, Inc. Marques déposées de Kimberly-Clark Worldwide, Inc. © KCWW. Smith & Wesson®, Magnum and 44 Magnum are registered trademarks and 38 Special, Magnum 3G and Sigma are trademarks used under license by Kimberly-Clark Professional*. DuPont™ and Tyvek® are registered marks owned by E.I. du Pont de Nemours & Co. VELCRO® is a registered trademark of Velcro Industries B.V. T78YNY 1/18



Place your order today
with your local representative

Find your local distributor
www.KCProfessional.com/distributor

Visit our website
www.KCProfessional.com

Effective January 2018